

D1 Block D - Elevation D1

1 : 200

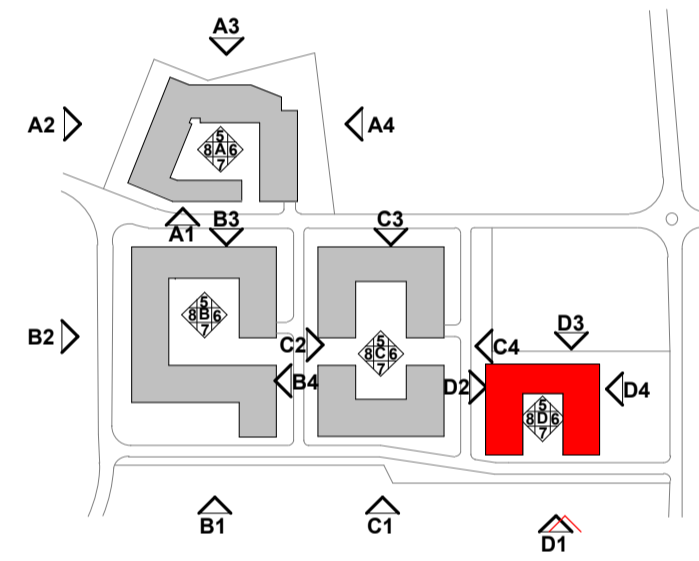

REV	DATE	SIGNED	NOTES

Project Stage

**SHD Application**

Client  
Joseph Costello, Absolute Limousines Ltd and Boherkill Property Development Ltd.

Project  
Lands west of Old Belgard Road and north, south and west of Cookstown Road, Cookstown Industrial Estate, Tallaght, Dublin 24

Drawing Title  
**BLOCK D - ELEVATIONS D1 & D2**

Drawn	Checked	Scale @ A1	Date
AB	SOD	1 : 200	18/11/19

Project No.	Drawing No.
19127	2113

Drawing BIM Name:  
P19127-CWO-04-ZZ-DR-A-2113

CDE Area	Suitability Code	Revision
	S2	



1 Sarsfield Quay, Arbour Hill, Dublin 7  
t: 01 518 0170 e: admin@cwoarchitects.ie  
Dublin | London | Warwick | Manchester  
www.cwoarchitects.ie



D2 Block D - Elevation D2

1 : 200